

CHAIN CONVEYOR TYPE RW

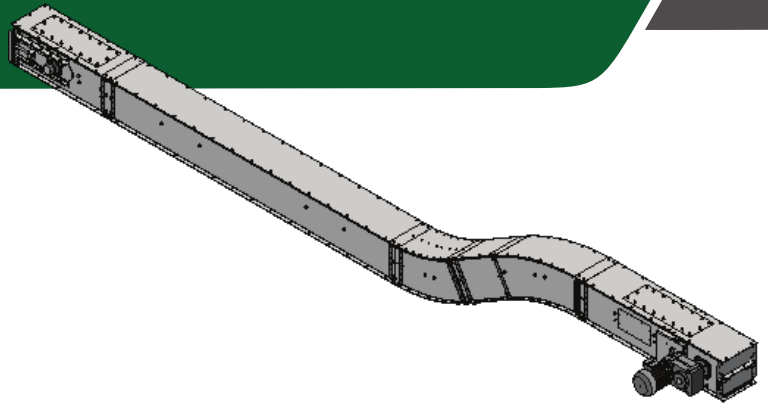

GENERAL

Brand	Cimbria
Model	RW Chain Conveyor
Chain speed	up to 0.27 m/s
Application	Moving dry bulk materials, such as sawdust, shavings and cereal residue

Cimbria type RW chain conveyor is designed for moving dry bulk materials such as sawdust, shavings and cereal residue.

The conveyor can be arranged for horizontal *and* inclined travel in one process, which makes for a cost-effective and efficient solution, in that one machine can accomplish what generally requires two.

The conveyor can be configured for reversible operation.

FEATURES

- Single bottom casing with chain runners
- Dual-side or top loading
- Single strand conveyor chain; pins-and-bush assembly; data sheet: *Conveyor Chain*
- Welded flights with bolted rubber flaps
- Manual chain tensioning at tail end

DRIVE SYSTEM

- Parallel shaft helical gearmotor, hollow shaft
- Gearmotor mounted on right or left hand side

CONTROLLERS

- Overflow sensing
- Rotation sensing
- Bearing heat sensing (optional)
- Explosion relief (optional); data sheet 50

ACCESSORIES

- Outlet for Q-pipe system
- Top covers for inlet sections
- Inspection windows
- Sun cover for gearmotor
- Support system; data sheet: *Chain Conveyor Support System*

Technical data

Maximum capacity	Horizontal	30 m ³ /h
	Angled (90°)	15 m ³ /h
Maximum bulk density	200 kg/m ³	
Drive motor size	According to application	
Chain speed	Up to 0.27 m/s	
Sound pressure level	75 to 85 dB(A)	
Maximum length and angle of slope	Depends on the material properties and the length and angle of the conveyor	
Operating conditions	Indoor and outdoor -15°C to +40°C ambient	

Materials

Casing	Pre-galvanised steel	
Chain	Steel, oil coated	
Chain runners	PEHD, antistatic	
Rubber flaps	SBR, antistatic	

Compliance

Atex	Standard	Zone 21 inside Non-zone outside
	Optional	Zone 22 or 21 outside

NOTE: Specific requirements apply for ATEX compliance.

CHAIN CONVEYOR TYPE RW

DIMENSIONS

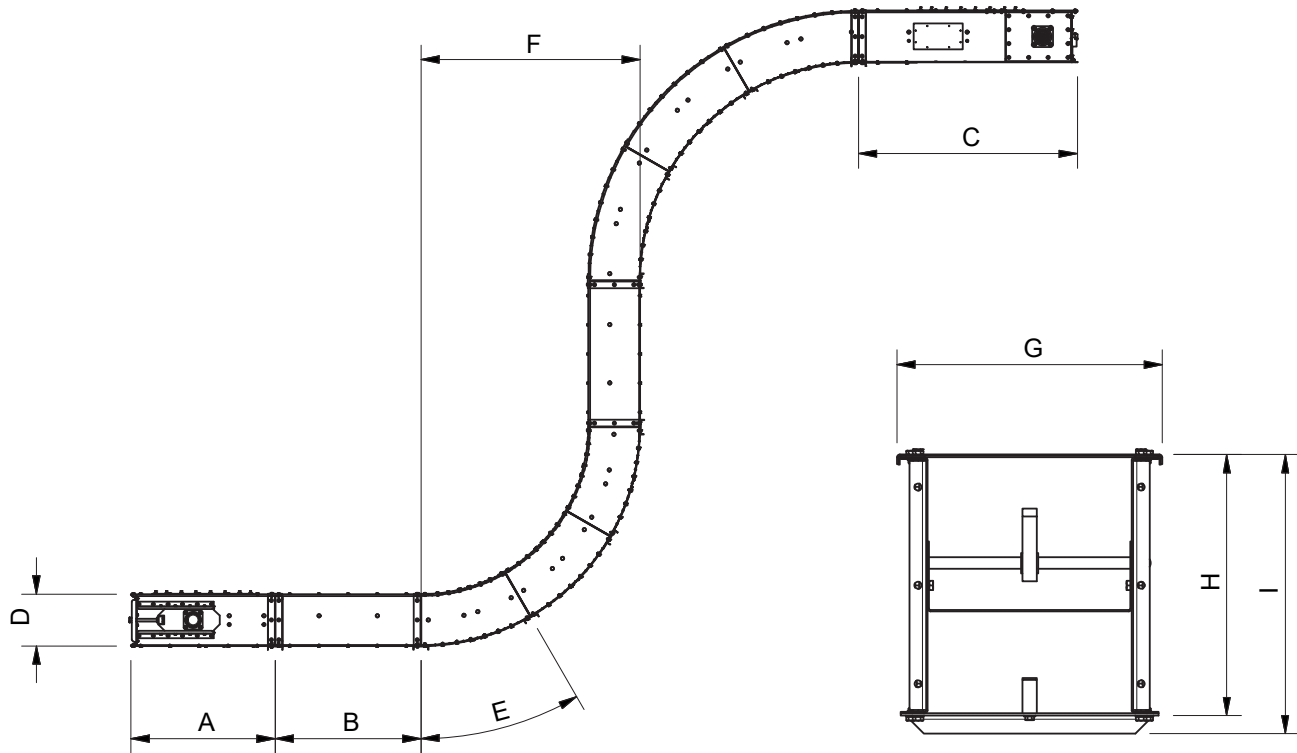

	A [mm]	B [mm]	C [mm]	D [mm]	E [mm]	F [mm]	G [mm]	H [mm]	I [mm]
RW-30	990	500 / 1 000 / 3 000	1 500	356	15° / 30°	1 500	364	358	383

	Grain layer thickness [mm]	Grain layer width [mm]	Thickness, top plate [mm]	Thickness, side plate [mm]	Thickness, bottom plate [mm]	Weight with material [kg/m] ¹	Driving section [kg] ²	Intermediate section [kg/m]	Tension section [kg]
RW-30	Up to 110	280	2	3	3	6.2	132	28	55

[¹] With material bulk density 200 kg/m³

[²] Weight of driving section without motor